

Cryogenic Stainless Steel Gate Valve

Bolted Bonnet - Extended Spindle

DN40 (1½")

Description

Stainless Steel extended spindle gate valve with bolted bonnet, integral soft seat and bronze internals. Available with butt weld ends, the valve has a wedge seat design for tight shut off designed to seal on downstream seat only in order to prevent liquid lock. The bolted bonnet allows for simple site maintenance, with easy access to the serviceable parts of the valve.

All valves are degreased for oxygen duty, assembled in clean room conditions and pressure tested prior to despatch.

Maximum Working Pressure (MWP)

(Subject to end connection)

40 bar (580 psi) at -196°C to +65°C

Body Strength Test 1.5xWP = 60 Bar (870 psi)

Features

- Unique Bestobell loose flange bolted bonnet design allows for thermal expansion and contraction and eliminates leakage at the bonnet gasket
- Precision investment cast body – smooth surface finish
- Lapped seat and PTFE seal ensure tight shut off at all times
- Lightweight design gives excellent thermal characteristics
- Anti-blow out spindle and one-piece high strength stem design for operator safety
- Long life, low torque stem thread
- Screwed and welded high strength extension tube and bonnet joints.
- Lightweight ergonomic handwheel
- Quick removal of headworks allows fast/easy maintenance
- 316 Stainless Steel construction with bronze internal components



Technical

Manual Gate Valves with bolted bonnet, extended bonnet, butt weld ends and PTFE seals. Actuated valves available.

ISO 9001 accreditation – design and manufacture to ASTM B31.3 & BSEN1626.

Optional full material traceability backed by BSEN 10204 3.1 / 3.2 Certification.

Designed and engineered for use with O₂, N₂, Ar, CO₂, He, Kr, Ne, H₂, C₂H₄ and N₂O service

CE Marking according to Pressure Equipment Directive 97/23/EC.

π Marking to Directive 99/36/EC only on written request complete with purchase order.

For other options please contact us.



Cryogenic Stainless Steel Gate Valve

DN40 (1½")

Materials

Body	ASTM A351 CF8M Stainless Steel
Bonnet	ASTM A276 316 Stainless Steel
Bonnet Flange	ASTM A351 CF8M Stainless Steel
Bonnet Insert	BSEN 12163 Phos. Bronze
Disc	BSEN 12163 Phos. Bronze/Virgin PTFE
Extension Tube	ASTM A312 TP 304L Stainless Steel
Wedge	ASTM A351 CF8M Stainless Steel
Stem	ASTM A276 316 Stainless Steel
Handwheel	BS1490 Aluminium
Handwheel Locknut	BS6105 A4 Gr.80 Stainless Steel
Gland Packing	Virgin PTFE
Gasket	Sigma 511
Fasteners	BS6105 A4 Gr.80 Stainless Steel

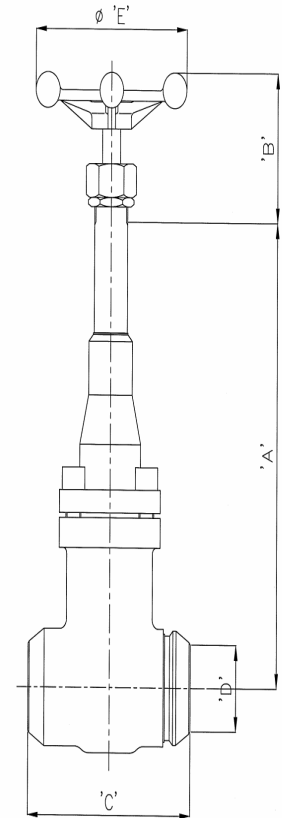

Specifications

Dimensions	Unit	DN 40 Bore (mm) 1.1/2 Bore (inches)
Part No		CMC70B1D3S00
* A	mm	230/300
B	mm	40
C	mm	130
D	mm	Butt Weld Sch'd 10
E	mm	121
Cv	US gpm	132
Weight	Kg	5.2

* Dimension A other lengths available to special orders / All dimensions / weights are approximate