



# C Series Specification Sheet

## 5 and 10 mm Continuous Level Transducers

Madison Company can engineer continuous level transducers to meet your application needs. Please provide the information requested below so that our Engineering Department can determine the appropriate design for your application.

Customer: \_\_\_\_\_ Contact Name: \_\_\_\_\_

Address: \_\_\_\_\_

Phone No.: \_\_\_\_\_ Fax No.: \_\_\_\_\_ E-Mail: \_\_\_\_\_

### MATERIALS

Wetted materials are 316 stainless steel, stem diameter is 0.5".

Float:  Polypropylene  Stainless Steel\*  Buna-N

\*1/2" NPT outside mount not available with stainless float

### REQUIREMENTS

Sensing Range (6" to 96" standard): \_\_\_\_\_

Resolution:  5mm (C3957)  10mm (C3946)

Signal Output:  
 3-wire – 1-5 VDC  
 2-wire – 4-20 mA  
 2-wire (resistive) – 1/10 W rating, 100 ohms per 5mm of indication

### TOTAL LENGTH

L Total: \_\_\_\_\_

### OPTIONS

- Temperature sensor
- High/low set point alarms

### MOUNTING

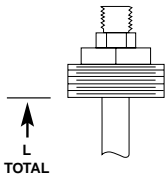

- Pipe Plug: Outside Mount  
 1 1/2"  2"

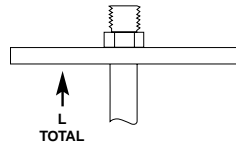

- Flange: Outside Mount  
 2"  3"  4"

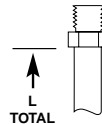

- NPT: Inside Mount  
 1/2"  3/4"  
 1"  1 1/2"

- Other mounting configuration  
(please describe below)

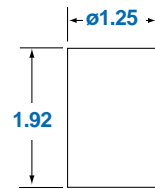

Buna-N Float

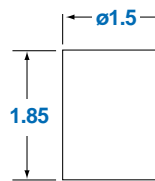

Polypropylene Float

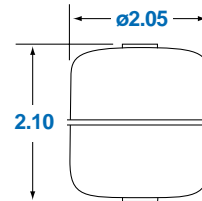

Stainless Steel Float

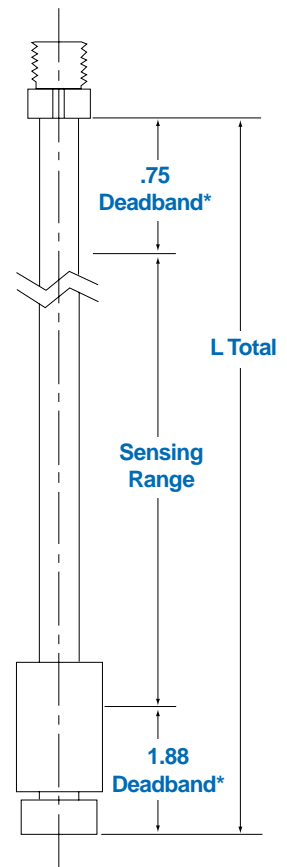

\* DEADBAND: EXTRA STEM LENGTH TO ALLOW FOR PROPER FLOAT TRAVEL OVER SENSING RANGE



Sensor solutions for today and the future™

## Madison Company

27 Business Park Dr., Branford, CT 06405  
800-466-5383 • 203-488-4477 • Fax: 203-481-5036  
www.madisonco.com • E-mail: info@madisonco.com

### NOTES

\_\_\_\_\_  
\_\_\_\_\_  
\_\_\_\_\_  
\_\_\_\_\_  
\_\_\_\_\_